

规格 / Specifications:

翼展 / Wingspan	1500 mm / 59 in
机长 / Length	1663 mm / 65.5 in
重量 / Weight	6.5 Kg / 14.3 ib (包括 1350ml 燃料 / Including 1350ml fuel)
建议发动机推力 / Recommended engine thrust	6~7 Kg / 13.2~15.4 ib

配置 / Configuration:

舵机 / Servo	25g×7 PCS, 12g×2 PCS
电池 / Battery	3S / 1500~1800 mAh×2 PCS (RX)



扫码关注，谢谢支持！

www.hsdr.com      www.hsdgo.com

hsd@hsdjetshuang sai.com

贵州省安顺市西秀区西秀产业园区标准化厂房 F6 栋 (邮编: 561099)

Building F6, Standardized Factory Buildings, Xixiu Industrial Park, Xixiu District, Anshun City,  
Guizhou Province, China (Post: 561099)

# HSDJETS®

## SUPER VIPER JET 超级毒蛇涡喷 快速组装说明 QUICK SETUP MANUAL

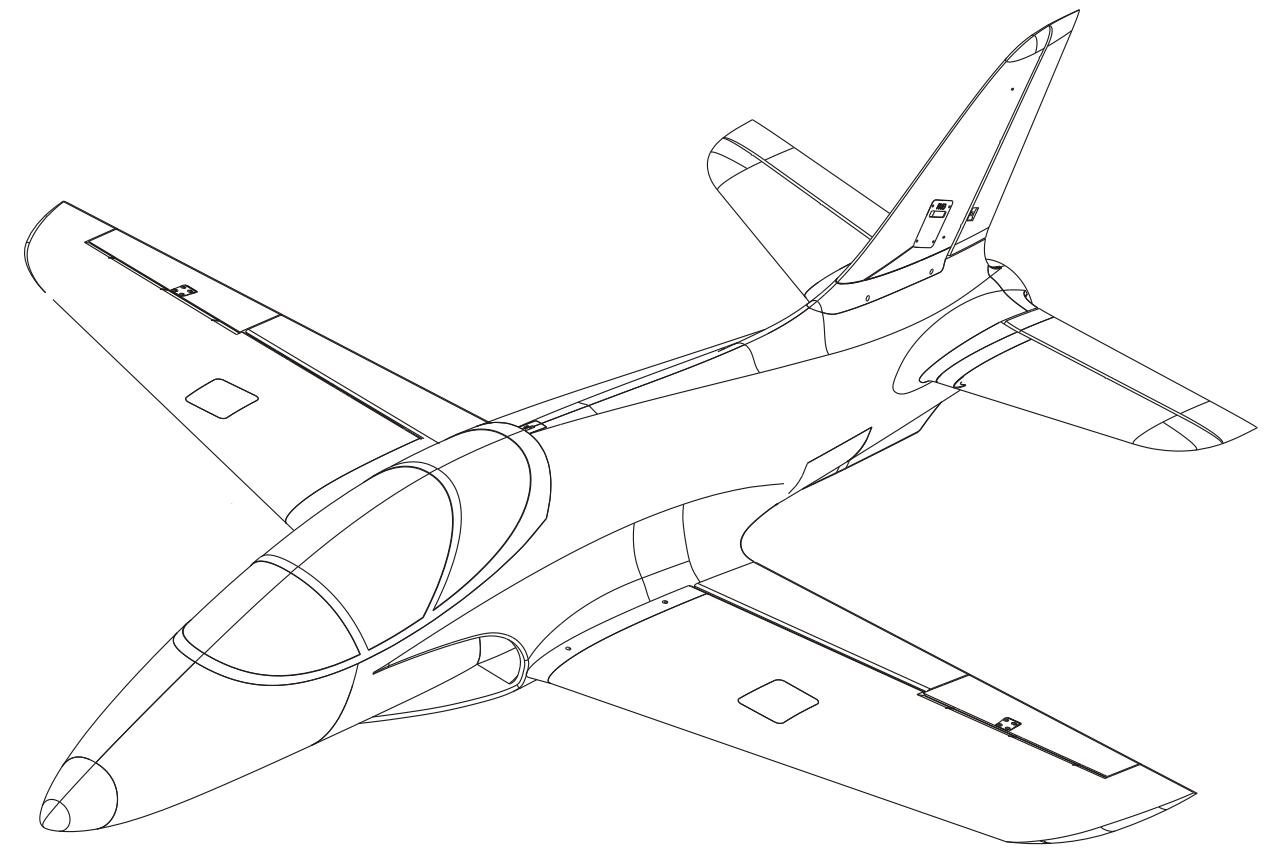

产品序列号:

想了解更多产品视频、图片、注意事项等信息

请登陆: www.hsdr.com

Want to learn more about the product video, pictures,  
and other matters of attention Please log in: www.hsdr.com

# SUPER VIPER JET

## 组装步骤 / ASSEMBLY

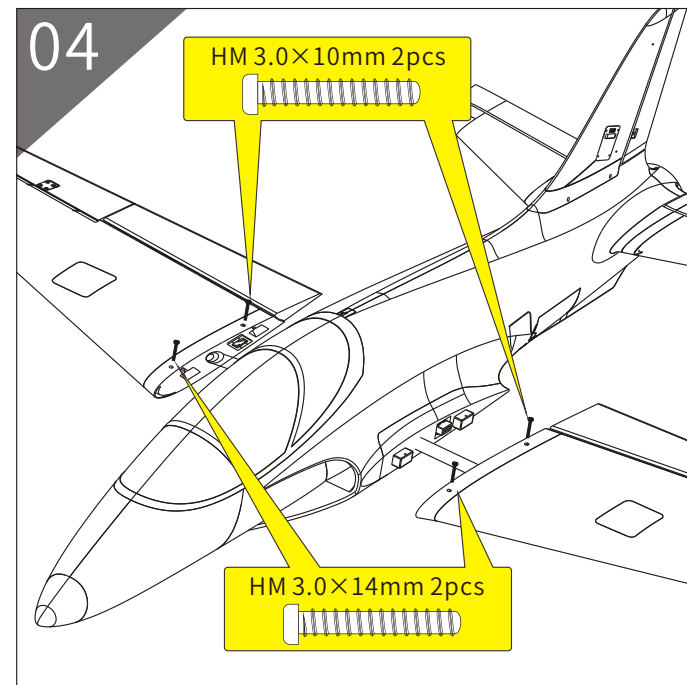
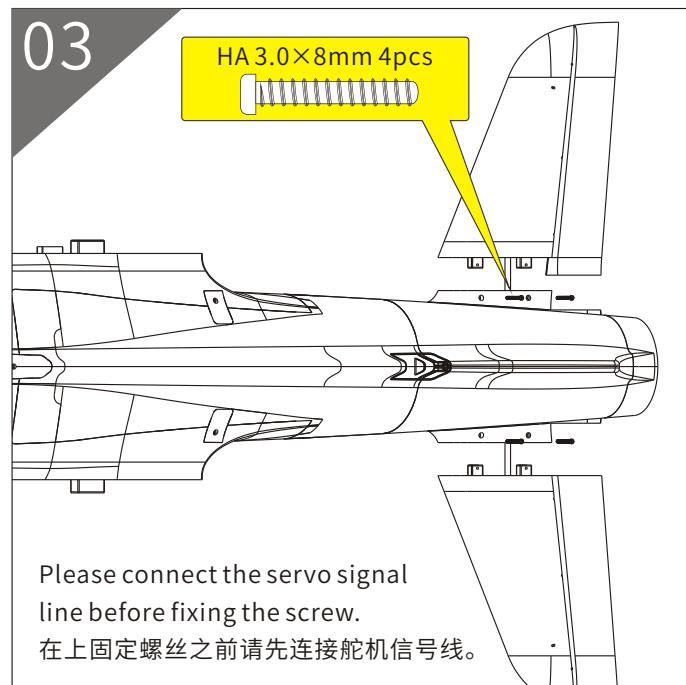
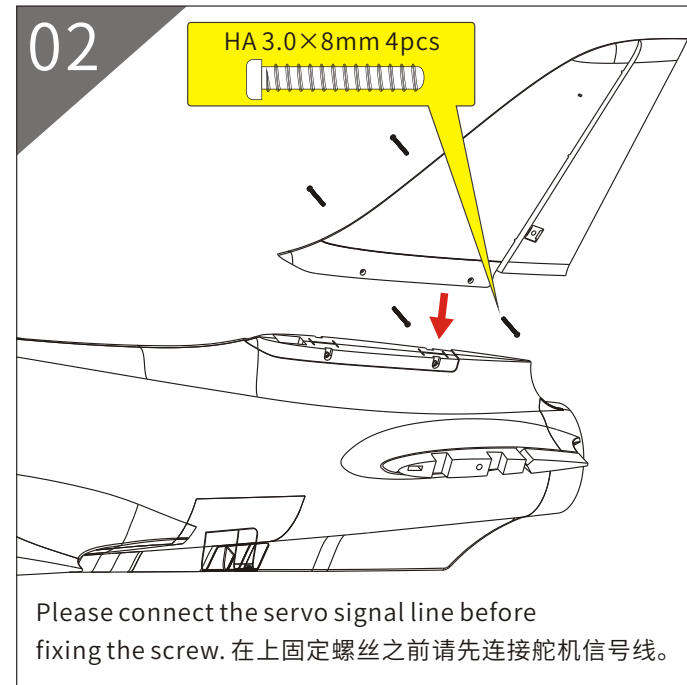
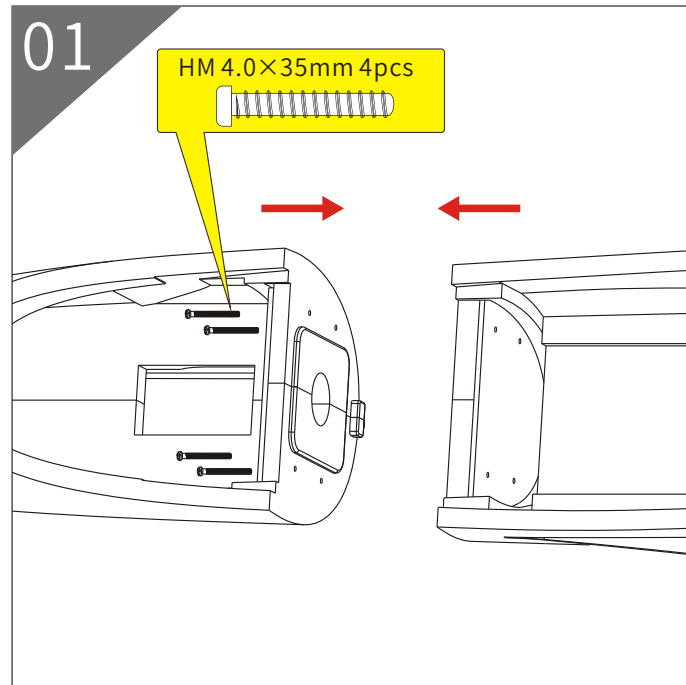

HSDJETS®

## 特别提醒 SPECIAL REMINDER

建议电池重量: 440g 完全匹配重心  
舵机供电双路 UBEC:  
3S, (1500~1800)mAh×2, Li-Po  
Recommended battery weight:  
440 g Fully matched center of gravity.  
Power supply UBEC for servos:  
3S, (1500~1800)mAh×2, Li-Po

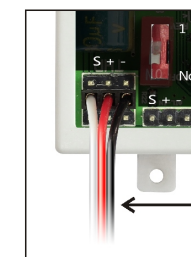

ECU 油门线  
ECU throttle cable

建议舵量:  
Recommand surface travel:

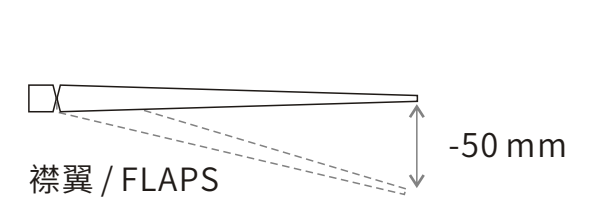
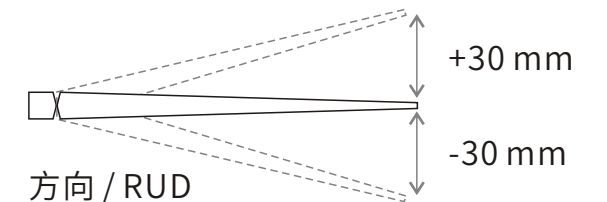
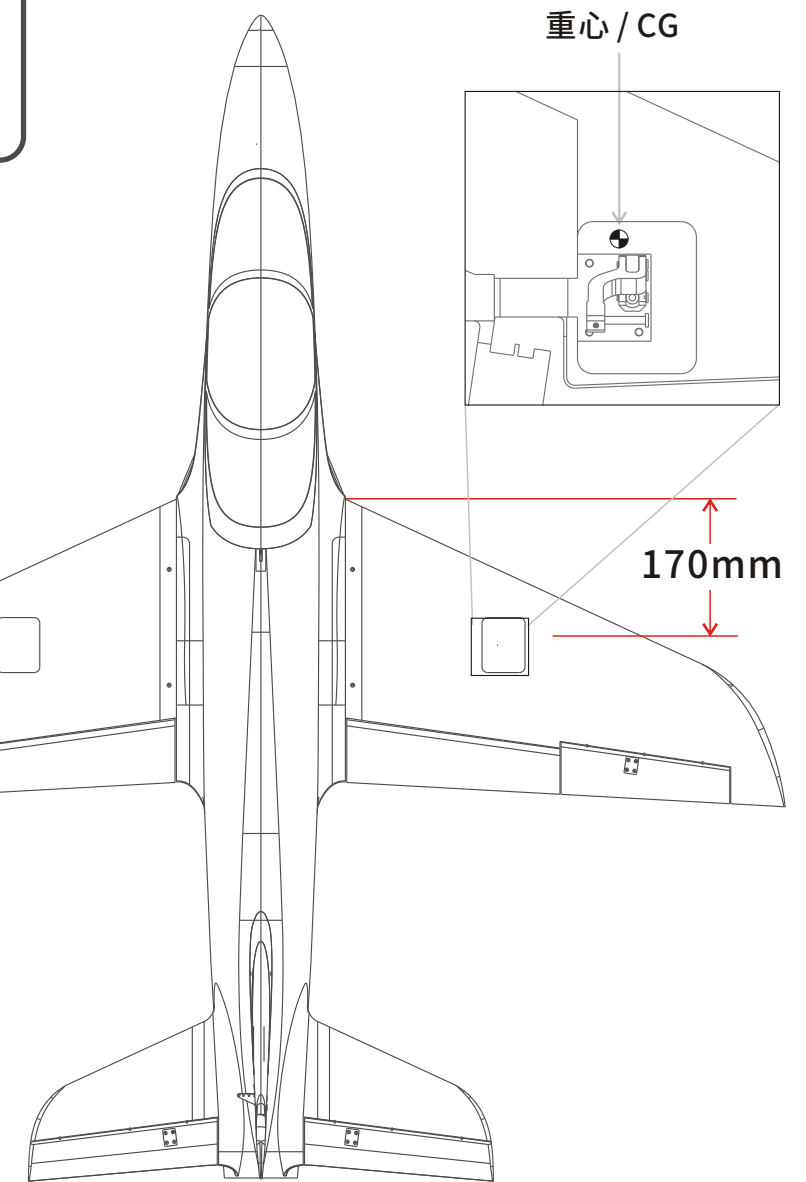
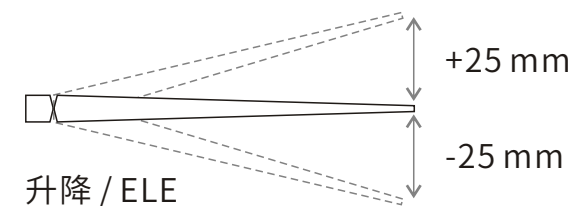
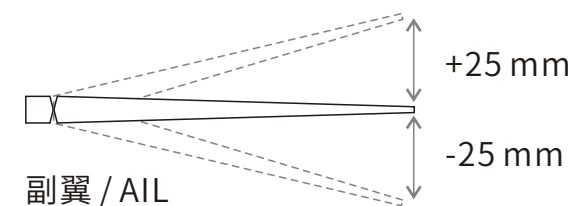

## 接线图 / CONNECTION GUIDE

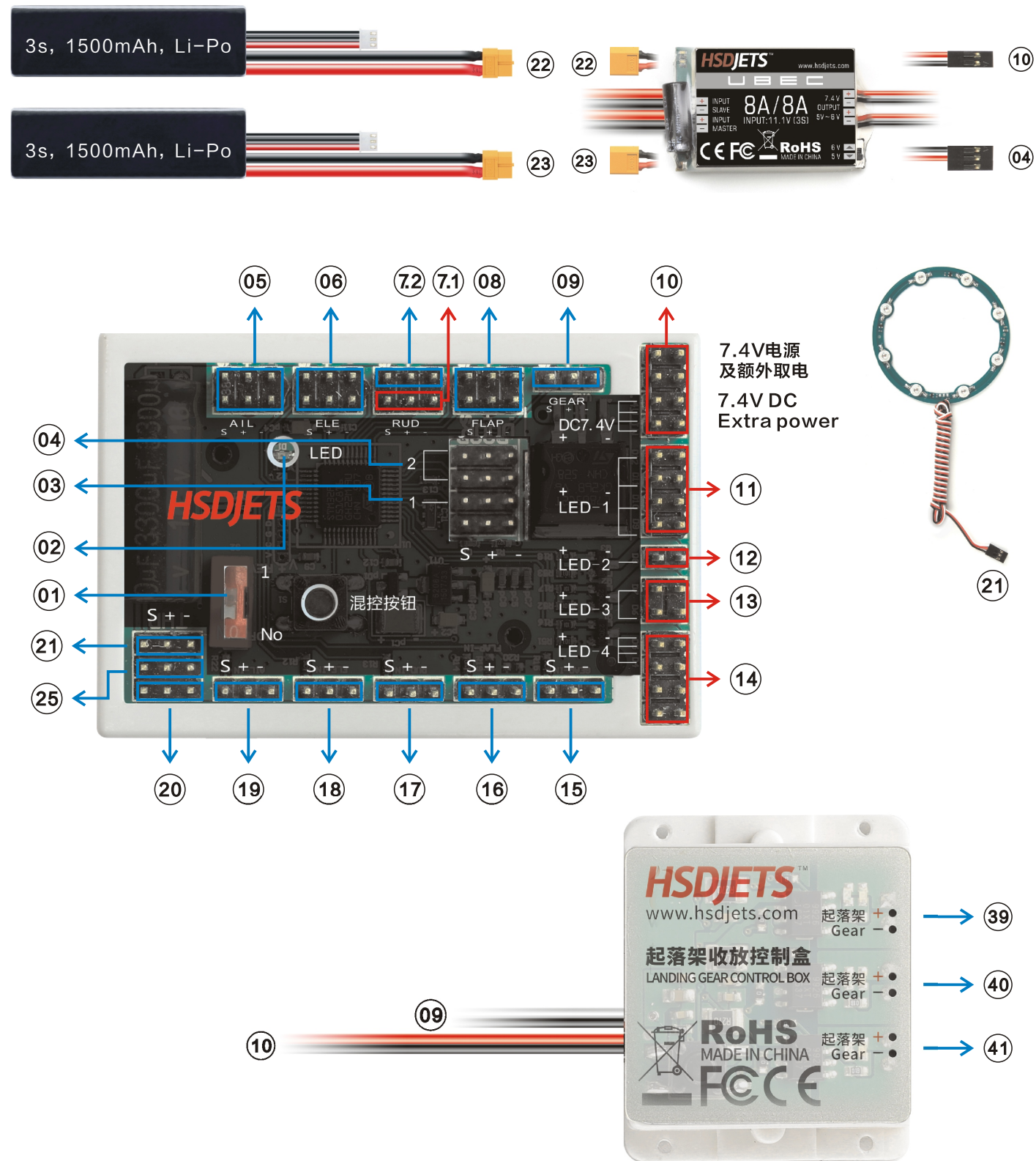

**!** 刹车输入电压出厂默认为: 7.4v, 如果想增大刹车力度, 请输入11.1v电压 (可采用发动机动力电池来供电)。  
The default voltage for braker is 7.4V,if you need increase strength of braker, use higher voltage.(ex:11.1V)

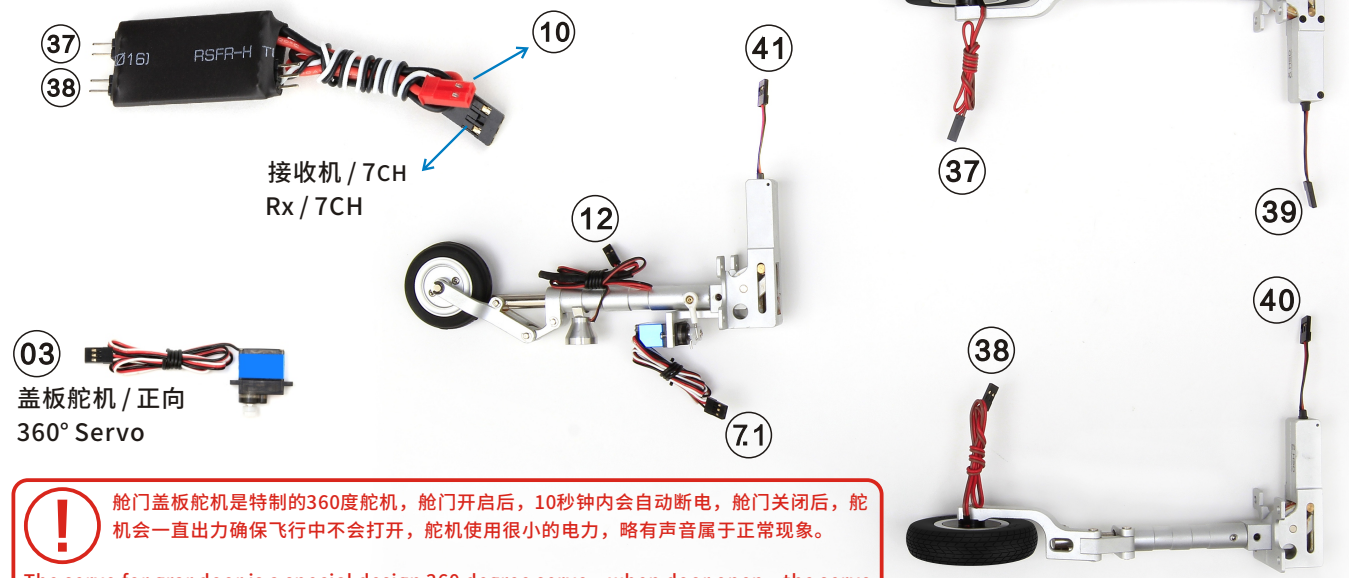

**!** 舱门盖板舵机是特制的360度舵机, 舱门开启后, 10秒钟内会自动断电, 舱门关闭后, 舵机会一直出力确保飞行中不会打开, 舵机使用很小的电力, 略有声音属于正常现象。  
The servo for gear door is a special design 360 degree servo, when door open, the servo will stop power in 10 second. when door close, the power will keep force, to avoid door open again in the air. the servo use a very small power, when door close, servo keep contiune force is safe for servo, enjoy flight!

- 01 反向舵机逆转开关  
Reverse Servos Reversing Switch
- 02 LED 指示灯  
LED
- 03 一次动作盖板端口  
Main landing gear cover control port
- 04 两次动作盖板端口  
Main landing gear cover multi control port
- 05 副翼舵机信号输入通道  
Aileron servos signal input channel
- 06 升降舵机信号输入通道  
Elevator machine signal input channel
- 07 前轮转向舵机信号输入通道  
Nose wheel steering servo signal input channel
- 08 方向舵机信号输入通道  
Rubber machine signal input channel
- 09 襟翼舵机信号输入通道  
Flap servos signal input channel
- 10 起落架信号输入通道  
Landing gear signal input channel
- 11 LED常亮端口  
LED Always port
- 12 前起落架灯端口  
Nose gear light port
- 13 LED快闪端口  
LED fast flash port
- 14 LED慢闪端口  
LED slow flash port
- 15 起落架通道  
Landing gear channel
- 16 襟翼通道  
Flap channel
- 17 方向通道  
Rubber channel
- 18 升降通道  
Elevator channel
- 19 副翼通道  
Aileron channel
- 20 油门通道  
Throttle channel
- 21 油门备用通道  
Alternate throttle channel
- 24 一键收放按钮  
A retractable button
- 25 ECU油门线  
ECU Throttle cable

# SUPER VIPER JET

## 起落架爆炸图 / DECOMPOSITION GRAPH



HSDJETS®

